

# Lyme stone paint Series

## 厦光莱姆石涂料



### 产品简介：

莱姆石也称德国石灰石，是由亿年前大量贝壳类小动物外壳化石演变而成，也被称为“生命之石”。厦光莱姆石涂料采用硅丙高分子乳液和无机材料为粘结剂，以烘焙沼泽土、精细天然石粉研制而成，该产品具有优异的耐候性、抗沾污性、防水性、永不褪色等优点。通过独具匠心的施工工艺，可以展现莱姆石梦幻纹理效果，尽显数亿年石材精华，是替代德国石灰石高级豪华型仿石涂料。

### Product features:

Lyme Stone, also known as German limestone, changes made by the million years ago a lot of shellfish fossils of small animal enclosure, also known as the "stone of life." Ha light lime stone coatings using silicone-acrylic polymer emulsion and inorganic binder material to bake burning swamp soil, developed from fine natural stone powder, the product has excellent weather resistance, stain resistance, water resistance, Wing do not fade and so on. Construction process by the distinctive, can show the effect of lime stone dreamy textures, filling hundreds of millions of years of stone essence, is an alternative to the German luxury stone-limestone advanced coatings.

### 性能特点：

- 梦幻石材效果
- 优异的保色性
- 憎水透气
- 豪华、厚重、自然
- 优异的耐沾污性
- 优异的耐候性
- 突出的抗开裂性
- 抗酸雨
- 高性价比

### Features:

- Dream Stone effect
- Excellent color retention
- Hydrophobic breathable
- Luxurious, thick, natural
- excellent stain resistance
- excellent weathering resistance
- Outstanding resistance to cracking
- Anti-Acid Rain
- Cost-effective



### 适用场所：

需要展现德国石灰石石材效果的建筑物墙面，尤其适合于别墅、排屋、中欧式建筑等高档建筑物。

### Application of places:

Germany needs to show the effect of limestone building stone walls, especially suitable for villas, townhouses, and other high buildings in the European architecture.

### 技术参数：

基 料：丙烯酸硅共聚乳液，无机高分子粘结剂。  
 颜 色：米黄色或提供来样。  
 产 品 特 征：水溶性、厚质。  
 干 燥 时 间：表干12小时，重涂时间24小时，实干48小时。（温度25℃，相对湿度80%）  
 理论耗漆量：2.50~3.00kg/m<sup>2</sup>，实际视基面粗糙程度、施工方法、花型不同有所差异。

### Technical parameters:

Base material: Acrylic silicone copolymer emulsion, inorganic polymer binder.  
 Color: Beige or provide sample.  
 Product Features: Water-soluble, Thick.  
 Drying time: dry for 12 hours, Recoat time 24 hours work for 48 hours. (Temperature 25°C, relative humidity 80%)  
 Consumption of paint: 2.50~3.00kg/m<sup>2</sup>, but the actual surface roughness, construction methods and designs varied.

### 施 工：

施工方法：（主料：批刮；点料：专用喷枪）。  
 稀释比例：一般不宜加水稀释，以免影响装饰效果。确因施工需要可酌加5%以内清水稀释。  
 施工要求：在5℃~35℃及相对湿度80%以下施工。大风、下雨等恶劣天气应避免施工。

### Technical parameters:

Construction methods: (Ingredients: shaved, material: special spray guns)  
 Dilution ratio: in general should not be diluted with water, so as not to affect the decorative effect. Indeed due to construction needs can be less than 5% water dilution  
 Construction Requirements: 5°C-35°C and relative humidity of 80% or less of construction. Wind, rain and other inclement weather construction should be avoided.

### 典型方案：

Typical scenario:

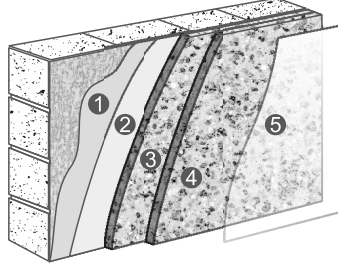

- ① 基层：厦光底层抗裂找平腻子/厦光中层柔性腻子2~3道
- ② 底层：厦光抗碱封闭底漆/厦光含沙专用底漆1道
- ③ 主材：厦光莱姆石主料3道
- ④ 色点：厦光莱姆石点料2~3道
- ⑤ 罩面：厦光罩面涂料1~2道

- ① Grassroots: Bottom crack leveling putty / Ha light middle flexible putty 2 - 3
- ② Bottom: Alkali-resistant primer/sediment-specific primer 1
- ③ Main material: Lime stone Ingredients 3
- ④ Color point: Lime stone material 2 to 3 points
- ⑤ Overlay: Washcoat 1 to 2

